



NDL Industries

APPLICATIONS

Commercial, Industrial, and Residential Hydronic and Plumbing systems

Water Press Ball Valves

Our precision-engineered water press ball valves deliver exceptional durability and performance, exceeding industry standards for pressure ratings and ensuring secure, lasting connections in hydronic and plumbing applications.



NPV Specifications

Durable Construction

Constructed from high-quality copper and other durable materials, water press ball valves are designed to endure the rigors of demanding plumbing applications. They resist corrosion and harsh conditions, offering long-lasting performance in residential and commercial systems.

Versatile Applications

Ideal for hydronic heating, potable water, and commercial plumbing, these valves offer the versatility and reliability professionals need. Their quick, user-friendly installation ensures efficient water flow. Built for performance and convenience, they streamline project completion.

Press Connections

Water press ball valves are a reliable and efficient solution for controlling water flow in plumbing and hydronic systems. Their press-connect design eliminates the need for traditional soldering or threading, streamlining installation and significantly reducing labor time. Engineered for both residential and commercial applications, these valves deliver consistent, long-lasting performance with minimal maintenance needs.

Quick and Leak-Proof Installation

Designed for fast, secure installations, water press ball valves create tight, leak-free seals. The press-fit system reduces maintenance needs and eliminates open-flame hazards, making installation safer, cleaner, and more efficient for professionals and DIYers alike.



Water Press Ball Valves

NPV Certifications and Approvals

- cUPC
- NF61
- NSF 372
- ASME B.16.51

1/2"-2"

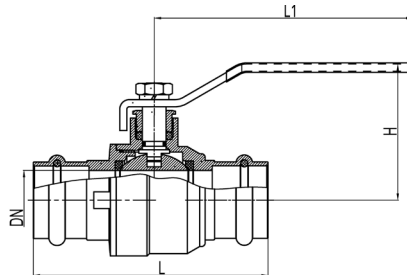

NPV Operating Parameters

- Maximum Working Pressure: 250 PSI
- Working Temperature: 203°F (95°C)

2 1/2"-4"

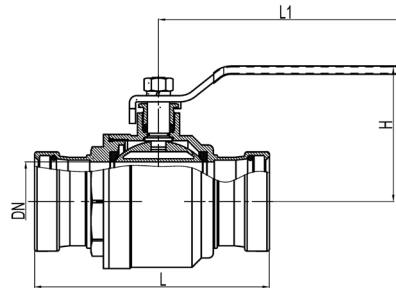

Hydronic Valves

Offering a wide selection of valves to fit your needs.

- Boiler Drain Valves and Quarter Turn Boiler Drain Valves are multi-purpose valves pressure.
- Gas Shut Off Valves feature PTFE seats and NBR O-Rings to reduce contamination buildup.
- Ball Valves have a lead-free, full port forged brass body, while Leaded Ball Valves have a leaded brass body.

NPV Dimensions

PART NUMBER	SIZE	DN (IN)	L (IN)	L1 (IN)	H (IN)	WEIGHT (LB)	WEIGHT (G)
NSV-012	1/2"	0.584"	3.152"	3.424"	1.790"	0.47	213.2
NPV-034	3/4"	0.739"	3.560"	4.241"	2.070"	0.807	366.0
NPV-100	1"	0.973"	3.872"	4.241"	2.226"	1.142	518.0
NPV-114	1-1/4"	1.245"	4.358"	5.564"	2.498"	1.669	757.0
NPV-112	1-1/2"	1.556"	5.292"	5.564"	2.712"	2.582	1171.2
NPV-200	2"	1.918"	6.420"	5.564"	3.004"	3.585	1626.1
NPV-212	2-1/2"	2.490"	7.374"	7.588"	4.202"	7.915	3590.2
NPV-300	3"	2.860"	8.074"	8.093"	4.533"	10.203	4628.0
NPV-400	4"	3.794"	9.767"	8.949"	5.428"	18.153	8234.1



Explore our full line of high-quality HVAC-R, CO₂ Refrigeration, and Hydronic products.

ndlindustries.com | 1-866-635-6888 | sales@ndlinc.com

@ndlindustries

