



NDL Industries

**APPLICATIONS**Commercial, Industrial, and Residential CO<sub>2</sub> Refrigeration

# Stainless Steel Check Valves (CO<sub>2</sub>-CVS)

NDL CO<sub>2</sub> check valves perform unlike any other in its class for leak prevention, reliability, and superior field performance.



## CO<sub>2</sub>-CVS Specifications

**Exceptional Safety Margins**

Our valves can hold *five* times their maximum working pressure, netting a tremendous safety margin for any ball valve used in CO<sub>2</sub> systems.

**Quality Tested**

Each valve is helium tested at the factory to guarantee leak-free performance.

**Bottom-Up Stem Installation**

Our stem placement is engineered from the bottom up. If there is an accidental over-pressurization in the valve, it will not blow the stem out and lose the charge.

**Stainless Steel Body**

The NDL CO<sub>2</sub> valves feature a stainless steel body for stainless steel connections.

**Size and Connections**

A wide range of sizes and connection types makes our valves compatible with main pipe types manufactured from copper iron alloys and stainless steel.

**Unparalleled Two-year Warranty**

Our warranty proves confidence, along with stamping every valve with a serial number and cleanly packaging in a poly-bag to prevent contamination and malfunctions.



# Stainless Steel Check Valves

## Operating Specifications

- Temperature: -40° to 302°F (-40°C to 150°C)
- Burst Pressure: 5 times the working pressure

## Certifications and Approvals

- CE
- RoHS
- UL-Listed

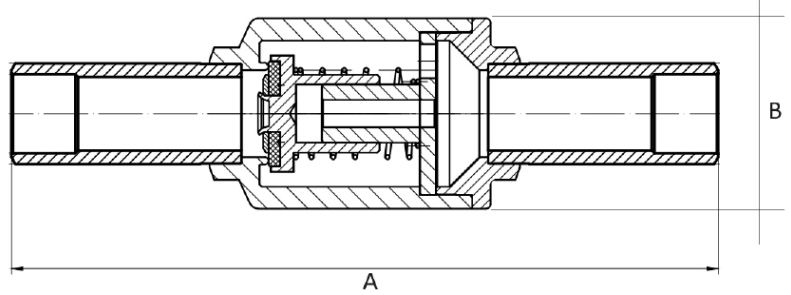

## Sizes, Kv/Cv, and Pressure Ratings

PART NUMBER	CONNECTIONS W	KV	CV	MAXIMUM OPERATING PRESSURE	
	MM	M3/H	GPM	BAR	PSI
CO2-CVS10M	10	2	2.3	140	2030
CO2-CVS12M	12	2	2.3	140	2030
CO2-CVS16M	16	3.6	4.2	140	2030
CO20CVS18M	18	3.6	4.2	140	2030
CO2-CVS22M	22	8.5	9.8	140	2030
CO2-CVS28M	28	19	22.0	140	2030
CO2-CVS32M	32	29	33.5	140	2030
CO2-CVS42M	42	38	43.9	140	2030